

**Planning and Environment Act 1987**  
**Wyndham Planning Scheme**  
**Approved Plan As Required**  
**under Condition 58**  
**Permit No WYP11430/19**  
**Date 06/02/2025**

ROAD NAME	ROAD CLASSIFICATION	RESERVE WIDTH (m)	ROAD WIDTH			KERB TYPE		VERGE WIDTH (m)	
			LIP TO LIP	INV TO INV	BACK TO BACK	NTH/WEST	STH/EAST	NTH/WEST	STH/EAST
FARLEIGH DRIVE	AS1	16.00	6.40	7.30	7.60	B2	B2	4.50	4.20
MEESIA WAY	AS1	16.00	6.40	7.30	7.60	B2	B2	4.50	4.20
VIRIDIS DRIVE	AS1	16.00	6.40	7.30	7.60	B2	B2	4.50	4.20
FIELDIA ROAD	AS1	16.00	6.40	7.30	7.60	B2	B2	4.20	4.50
GALUIM ROAD	AS1	16.00	6.40	7.30	7.60	B2	B2	4.50	4.20

LEGEND	
	PROPOSED STAGE BOUNDARY
	5.0 PROPOSED DESIGN CONTOURS
	PROPOSED KERB & CHANNEL
	FALL OF ALLOTMENT
	DIRECTION OF OVERLAND FLOW
	FUTURE/EXISTING STAGE BOUNDARY
	PROPOSED RIDGE LINE
FR219.40	FINISHED RIDGE LEVEL
FS219.42	FINISHED SURFACE LEVEL
21.22	EXISTING SURFACE LEVEL
TW54.65	TOP OF WALL LEVEL
BW53.65	BOTTOM OF WALL LEVEL
	PROPOSED ROAD PAVEMENT
	PROPOSED CONCRETE FOOTPATH / VEHICLE CROSSING
	CUT (> 0.3m)
	FILL (> 0.3m)
	PROPOSED RETAINING WALL
	SUBSOIL DRAINAGE PIPE
	TEMPORARY CUT OFF DRAIN
	PROPOSED STORMWATER DRAINAGE
S	PROPOSED SEWERAGE RETICULATION
W	PROPOSED WATER RETICULATION
E	PROPOSED ELECTRICITY UNDER GROUND
C	PROPOSED COMMUNICATIONS
G	PROPOSED GAS RETICULATION
R	PROPOSED RECYCLED WATER RETICULATION
H	PROPOSED DRAINAGE INLET
	PROPOSED GAS / RECYCLED WATER / POTABLE WATER HOUSE CONNECTIONS
	EXISTING STORMWATER DRAINAGE
s	EXISTING SEWER RETICULATION
w	EXISTING WATER RETICULATION
r	EXISTING RECYCLED WATER RETICULATION
e	EXISTING ELECTRICITY UNDER GROUND
c	EXISTING COMMUNICATIONS
g	EXISTING GAS RETICULATION
	EXISTING FENCE
	FUTS/WD FUTURE STORMWATER DRAINAGE
	FUTS FUTURE SEWER RETICULATION
	FUTW FUTURE WATER RETICULATION
	FUTR FUTURE RECYCLED WATER RETICULATION
	FUTE FUTURE ELECTRICITY UNDER GROUND
	FUTC FUTURE COMMUNICATIONS
	EXISTING TREES TO BE RETAINED

**NOTE:**  
 FOR GENERAL NOTES, REFER TO DRAWING NO. 30063302-AAP-AA13DD-CV-DRG-0002.

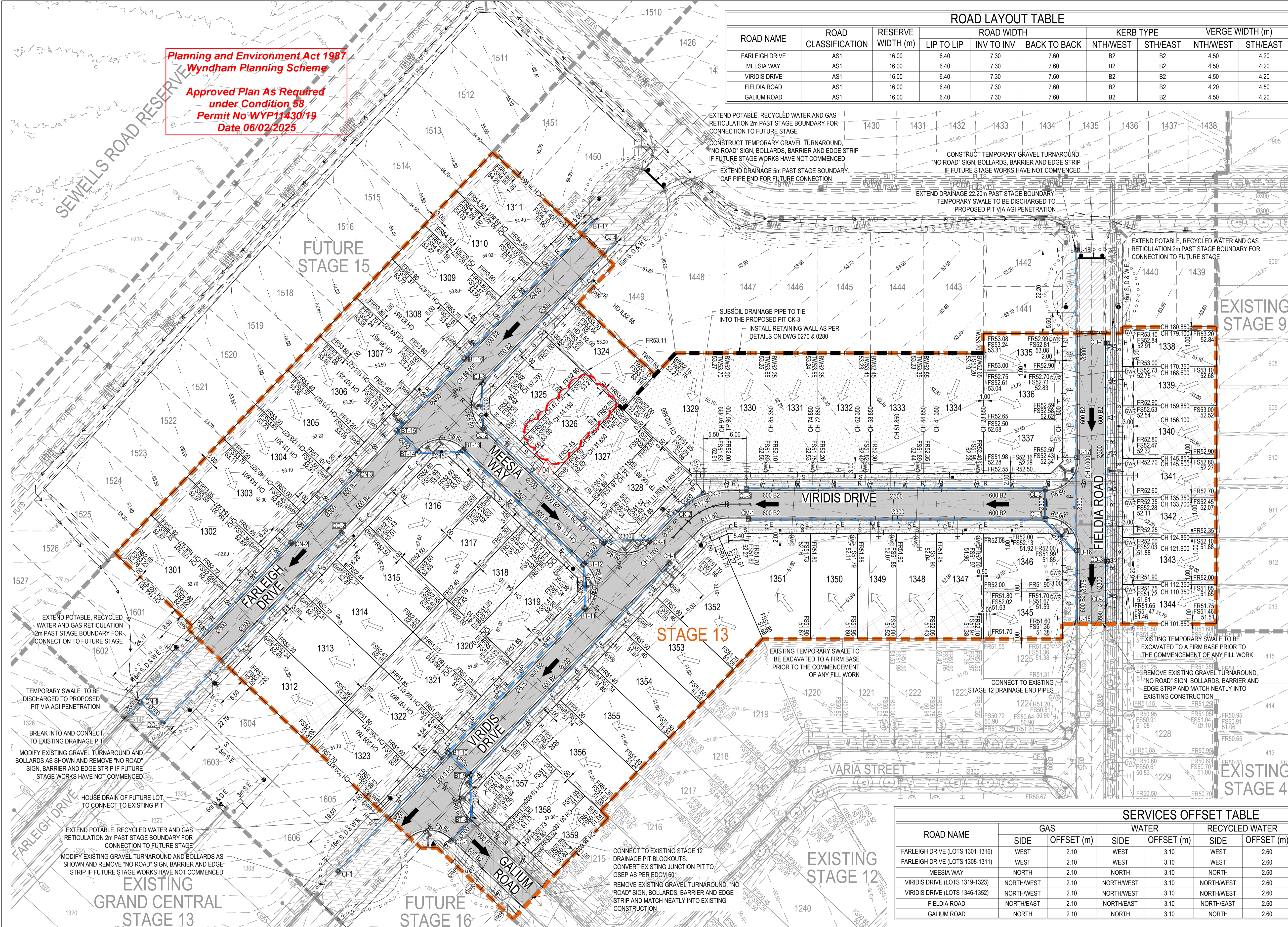

ROAD NAME	GAS		WATER		RECYCLED WATER		ELECTRICITY		COMMUNICATIONS	
	SIDE	OFFSET (m)	SIDE	OFFSET (m)	SIDE	OFFSET (m)	SIDE	OFFSET (m)	SIDE	OFFSET (m)
FARLEIGH DRIVE (LOTS 1301-1316)	WEST	2.10	WEST	3.10	WEST	2.60	EAST	2.50	EAST	1.80
FARLEIGH DRIVE (LOTS 1308-1311)	WEST	2.10	WEST	3.10	WEST	2.60	EAST	2.40	EAST	1.80
MEESIA WAY	NORTH	2.10	NORTH	3.10	NORTH	2.60	SOUTH	2.40	SOUTH	1.80
VIRIDIS DRIVE (LOTS 1319-1323)	NORTHWEST	2.10	NORTHWEST	3.10	NORTHWEST	2.60	EAST	2.40	SOUTHEAST	1.80
VIRIDIS DRIVE (LOTS 1346-1352)	NORTHWEST	2.10	NORTHWEST	3.10	NORTHWEST	2.60	EAST	2.50	SOUTHEAST	1.80
FIELDIA ROAD	NORTHEAST	2.10	NORTHEAST	3.10	NORTHEAST	2.60	SOUTHWEST	2.35	SOUTHWEST	1.80
GALUIM ROAD	NORTH	2.10	NORTH	3.10	NORTH	2.60	SOUTH	2.50	SOUTH	1.80

Issue	Description	DR	CH	VE	Date
04	AMENDED LOT 1326 LEVELS	HP	SH	SG	05.02.25
03	AMENDED LOT LEVELS	HP	SH	SG	16.01.25
02	AMENDED AS PER COUNCIL COMMENTS	HP	SH	SG	17.12.24
01	ISSUED FOR APPROVAL	HP	SH	SG	23.10.24

Scales

1 : 500

Client

HB Land  
A member of Ho Bee Land

Status

**FOR APPROVAL**  
 NOT TO BE USED FOR CONSTRUCTION

© Copyright reserved

Original Issue Signatures

Drawn	H.PALOMIQUE	Original Size	A1
Designed	S.HARMANIS	Height Datum	AHD
Project Manager	E.GAVILANEZ	Grid	MGA
Verified	S.GILBERT		

Project

**UNITY PARK**  
**STAGE 13**  
 WYNDHAM CITY COUNCIL

Title

**ROADWORKS AND DRAINAGE**  
**LAYOUT PLAN**

Arcadis Australia Pacific Pty Limited  
 Level 18, Queen and Collins Tower  
 376-390 Collins Street  
 Melbourne VIC 3000  
 ABN 76 104 485 289  
 Tel No: +61 3 8623 4000  
 www.arcadis.com/au

Project No. | Originator | Zone | Stage | Phase | Discipline | Type | Drawing No. | Issue

30063302 - AAP - AA13DD - CV - DRG - 0220 - 04